

PROBLEM *Solver*[™] BULLETIN

Corroded Tie Rod Ends

Dodge/Plymouth Neon,
Chrysler PT Cruiser

www.moogproblemsolver.com

PROBLEM:

Corroded Tie Rod Ends

The OEM outer tie rod from the factory uses a stamped steel housing. This housing has a seam at the top which can allow water to enter and collect in the cavity for toe adjustment. A corrosion build up in this area can make wheel alignment difficult. The original tie rod uses a plastic bearing and is not greaseable which can affect its service life.

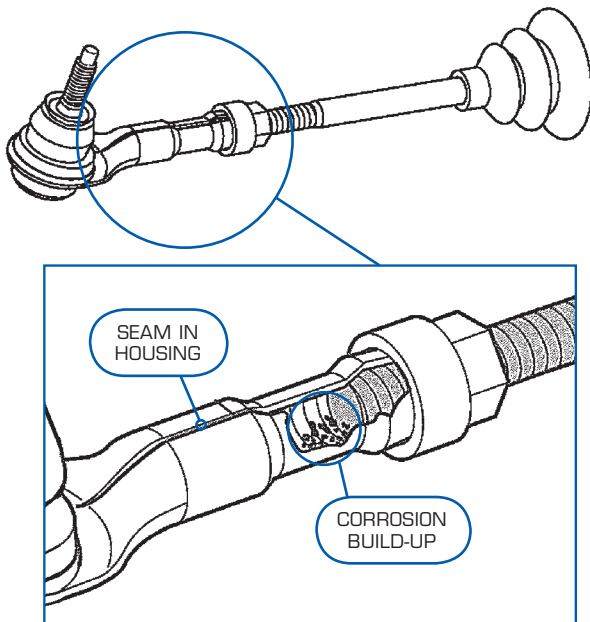

Description	Years	Make/Model	Replacement Part Number
Outer Tie Rod	2001-2006	Chrysler PT Cruiser	ES3173RL
	1995-2005	Dodge Neon	
	1995-2001	Plymouth Neon	

SOLUTION:

MOOG® ES3173RL Outer Tie Rod



The MOOG design utilizes a solid forged housing, eliminating the seam and adding strength. It is greaseable to help extend service life. The design also uses a traditional castellated nut, cotter pin and wrench flats to ease installation. In addition, it uses the patented pressed-in cover plate design to provide long life and durability.

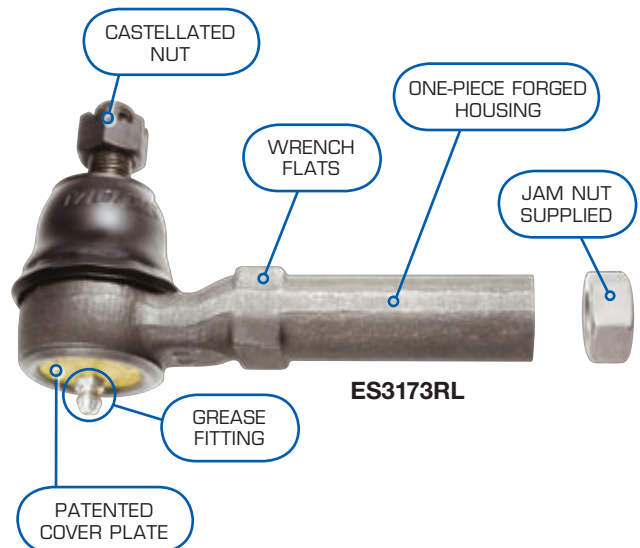

THE PROBLEM SOLVER™

